

## INSTALLATION SONOREX® FIRE- RESISTANT NOISE BARRIERS WITH EASY MASS FOIL

SONOREX® 40 Fire  
SONOREX® 41 Fire  
SONOREX® 43 Fire  
SONOREX® 47 Fire

### REQUIRED SONOREX® PRODUCTS

- SONOREX® noise barriers
- SONOREX® loose mineral wool
- SONOREX® tape
- SONOREX® Easy Mass (light) foil
- SONOREX® securing screws
- Fire-resistant adhesive (consult our Customer Service for advice)

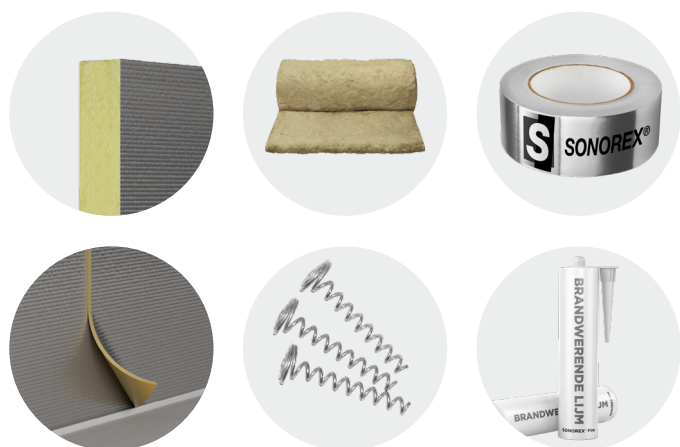

### REQUIRED TOOLS (NOT INCLUDED)

- Measuring tools
- Insulation knife, handsaw, or jigsaw
- Sealant gun
- Utility knife

### INSTALLATION OF NOISE BARRIERS

- 1 Check the fire classification of the adjacent ceiling. If the fire classification is lower than Class C, install a single strip of fire-resistant gypsum board (Gyproc RF or Type DF plasterboard) with a thickness of 15 mm and a width of 60 mm into the ceiling grid. If the ceiling has a fire classification of Class C or higher, this step is not required.
- ② Measure the distance between the bottom of the ceiling grid and the overhead structure.
- 3 If necessary, cut the SONOREX® noise barriers to the required dimensions using an insulation knife or handsaw.
- 4 Insert the bottom of the noise barrier into the ceiling grid and tilt the barrier into position.
- 5 Press the noise barrier firmly and gap-free against the overhead structure. Fill any gaps with SONOREX® loose mineral wool.
- 6 Install the next barrier in the same way, ensuring a tight fit between adjacent barriers. Fill any gaps with SONOREX® loose mineral wool.
- ⑦ Ensure that suspension elements, such as quick-release or adjustable hangers, are fully enclosed between the two SONOREX® noise barriers.

- ⑧ Once all noise barriers are in place, apply fire-resistant adhesive to seal all joints between barriers and the connections to the building structure.
- ⑨ Finally, finish the connections to the building structure and the joints between barriers **on both sides of the assembly** using SONOREX® tape.

#### INSTALLATION OF EASY MASS FOIL

- ⑩ Measure the height between the top of the ceiling grid and the bottom side of the overhead structure. Cut the SONOREX® Easy Mass (light) foil to the precise dimensions using a utility knife.
- 11 Remove the release liner and start applying the foil from the top of the ceiling grid. Apply the foil evenly onto the noise barrier, moving upwards toward the top edge of the barrier. Avoid trapping air between the Easy Mass (light) foil and the noise barrier.
- 12 The SONOREX® Easy Mass (light) foil is self-adhesive. However, to ensure long-term quality of the noise barriers, we recommend securing the SONOREX® Easy Mass (light) foil additionally with SONOREX® securing screws. This will not negatively impact the sound insulation. Fasten the SONOREX® securing screws into the noise barrier following the pattern shown in the image below.

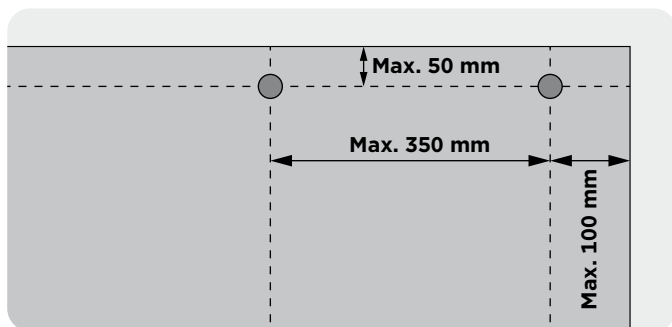

If the SONOREX® noise barriers are delivered to the construction site with the Easy Mass foil pre-applied (off-site), the connection on one side to the building structure, as well as the joints between the Easy Mass foil, must still be finished using SONOREX® tape.

#### ADDITIONAL STABILISATION

For certain wall heights, additional stabilisation may be required. One method is to brace the ceiling grid back to the overhead concrete floor. These braces – such as nonius hangers placed at approximately 45 degrees – must be installed a maximum of 2.4 meters apart and on both sides of the wall. The table below indicates when additional stabilisation is necessary.

Fire requirements	Performance	Maximum wall height (incl. SONOREX®)	Maximum height SONOREX®	Need of bracing?
Fire resistance in minutes	30 min.	4 meters	600 mm	No
	60 min.	3 meters	600 mm	No
	60 min.	4 meters	930 mm	Yes
Smoke permeability	Sa & S200	No maximum	1200 mm	No

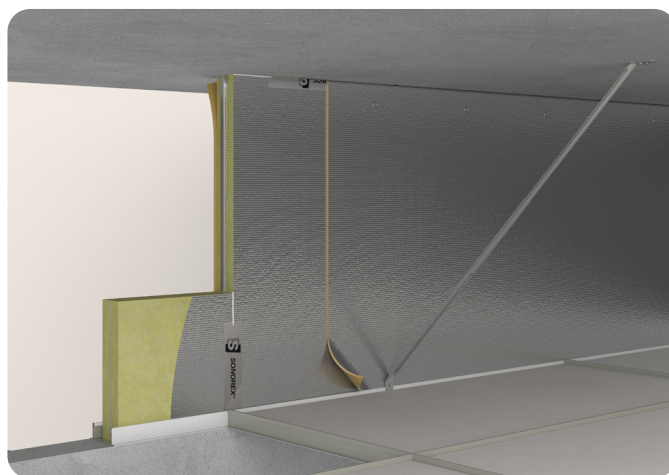

#### FIRE-RESISTANT PENETRATIONS

Penetrations – such as ducts, pipes, or cable trays – in SONOREX® fire-resistant noise barriers can cause unwanted sound leaks and rapid fire spread from one room to another. In such cases, the sound insulation and fire resistance values specified in the product datasheet may be negatively affected. Therefore, avoid penetrations as much as possible.

If this is not possible, Promat fire-resistant service penetrations must be used in combination with a PROMASTOP®-CC barrier at the location of the penetration. Always verify in advance whether the Promat fire-resistant penetrations have been tested in combination with the PROMASTOP®-CC barrier. The maximum allowable height of the PROMASTOP®-CC barrier in this application is 800 mm. Installing multiple PROMASTOP®-CC barriers side by side is not permitted.

- As with the SONOREX® fire-resistant noise barrier, measure and mark the PROMASTOP®-CC barrier generously, then cut it to size.
- Apply PROMASTOP®-CC fire-resistant coating to the cut edges of the PROMASTOP®-CC barrier.
- Place the bottom edge of the PROMASTOP®-CC barrier into the ceiling grid and tilt it into position. Press the barrier firmly and gap-free against the overhead structure. Fill any gaps with SONOREX® loose mineral wool.

- Next, install the SONOREX® fire-resistant noise barrier directly against the PROMASTOP®-CC barrier. Apply PROMASTOP®-CC fire-resistant coating to the cut edges of the SONOREX® barrier at the connection point, as well as to the ceiling grid and the surrounding building structure.
- After installation, apply PROMASTOP®-CC fire-resistant coating to the SONOREX® fire-resistant noise barrier over a width of 100 mm from the joint with the PROMASTOP®-CC barrier. Repeat this at the connection with the building structure.  
**Note: do not remove the aluminium foil from the SONOREX® noise barrier.**
- For the fire-resistant installation of service penetrations in the PROMASTOP®-CC barrier, please refer to the Promat installation manual.

#### CONTACT

Do you have any questions about applications, dimensions, customizations (cut-outs), penetrations, or connections? Please contact our specialists at Customer Service.

☎ +31 (0)13 578 48 87

✉ [sales.is@saint-gobain-solutions](mailto:sales.is@saint-gobain-solutions)

[saint-gobain-solutions.nl/sonorex](https://saint-gobain-solutions.nl/sonorex)

**The Saint-Gobain Solutions advisory conditions apply to these installation instructions. Changes are reserved. Therefore, always consult the latest version at [saint-gobain-solutions.nl](https://saint-gobain-solutions.nl). In addition, project-specific agreements that differ from these installation instructions have priority.**

